

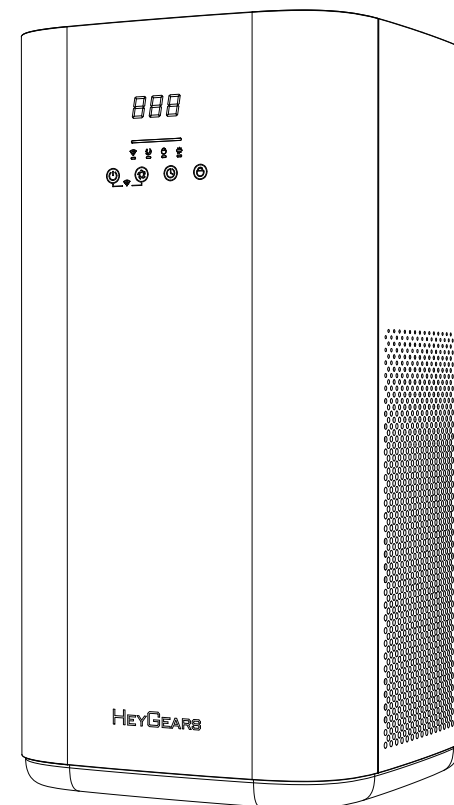

ULTRACRAFT GreenPrint

3D Printing purification System



heygears.com

info@heygears.com

Tel: +1 (318) 353-4295 (Global) / +1 (949) 418-9418 (USA) / +44 148-396-8549 (EU)

USA-17931 Sky Park Circle, Suite E, Irvine, CA, 92614
CHN-Block B2, 501, 601, Enterprise Accelerator, Kaifu District, Guangzhou City

Follow us @HeyGears



Please make sure to read and understand this Quick Start before unpacking and installing.

Thank you for choosing HeyGears. For your own safety, please operate as per this Quick Start. If you fail to comply with the instructions in this manual, HeyGears will not be liable for the consequential damages unless required by all applicable laws and regulations.

Please keep this operation manual properly for future reference. The pictures are for reference only and the products are subject to the actual product.

1 Items & Parameters



GreenPrint Purification Unit
X1



Power Cord
X1



Power adapter
X1



Filter strip
X10

Name	UltraCraft 3D Printing Purification System	Input	24 V \Rightarrow 3.5 A
Model	UltraCraft GreenPrint Purification Unit	Weight	7 kg
Dimensions	270*270*520 mm	Power	84 W (at Speed 3)

2 Components



3 Installation Requirements

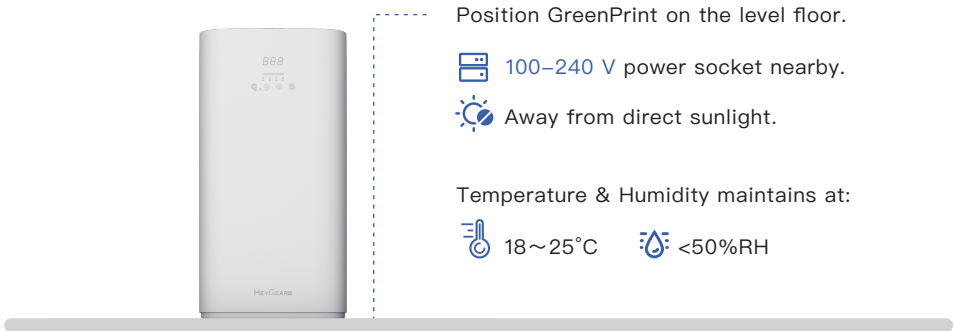

4 Operation Steps

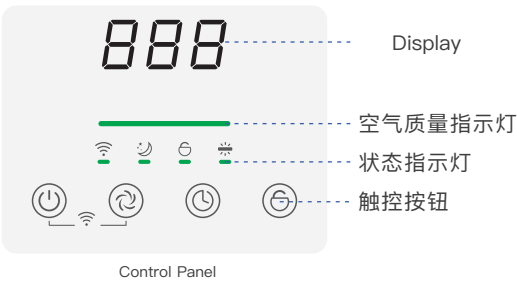

Display:
Powered on, the unit will preheat for 180 sec, during which a countdown will be displayed here. Once the countdown ends, the unit will show the detected TVOC concentration, wind speed, timer, and other information."

Air quality indicator:

- Green: Extra low TVOC concentration
- Blue: Low TVOC concentration
- Yellow: Moderate TVOC concentration
- Red: High TVOC concentration

Status indicators from left to right:

- Wi-Fi indicator
- Sleep mode indicator
- Safety lock indicator
- Photocatalyst model status indicator.

- STEP 1** Put the device on the level ground and check if it's intact. Open its rear cover and take out the filler inside. Then plug the provided power cord in the position as the image shows.

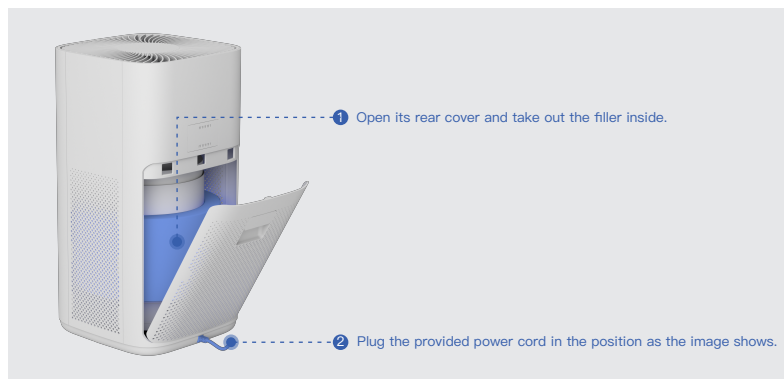

- STEP 2** Connect the device to power. Then operate via the buttons.

On/off

Press to start or shut down the purification unit. The unit defaults to Speed 2.

Speed

Press to switch the speeds—Speed 1/Speed 2/Speed 3/Sleep. The Sleep mode wind speed is the same as Speed 1, but it will turn off all the lighting with only the sleep mode indicator slightly illuminated. Please choose the speed based on the environment. In most scenarios, the best purification effect is achieved at Speed 3.

Timer

Press to enter the timer setting on the display, and continue to press to set the timer. One press adds one hour. The timer can cycle within a range of 0 to 12 hours. Set the timer while the device is powered on, it will shut down after the timer ends; set the timer while the it is powered off, it will turn on after the timer ends. When the display has entered the timer setting, it will apply and leave the setting after 5 sec of inactivity.

Safety lock

Press and hold for 2 sec (when the device is on) to lock the machine, when the safety lock indicator is solid on and all buttons except for the lock button are locked. Press and hold the button for 2 sec again to unlock it.

5 Network Connection

- STEP 1** Please download and sign up for BlueprintGo App by scanning the QR code below.



Android



ios

- STEP 2** When the unit is on, press and hold On/off + Speed buttons simultaneously for 2 sec, the unit enters Wi-Fi connecting as it prompts with a sound and the Wi-Fi indicator blinks.

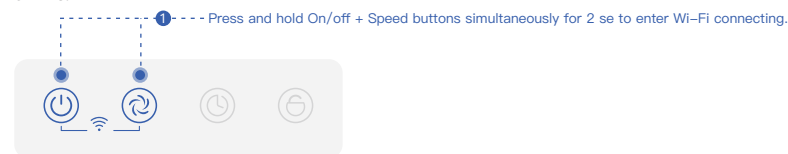

- STEP 3** Finish Wi-Fi setup and device binding on Blueprint Go. When the unit has successfully connected to networks, the Wi-Fi indicator is solid on.

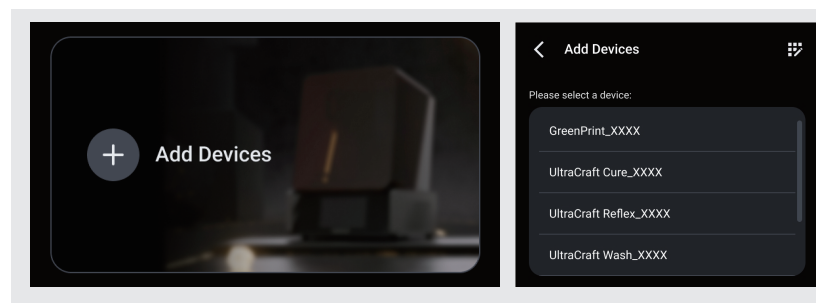

6 Filter Strip Replacement

The filter strip adsorbs dust during the use and when the dust accumulates to a certain extent, it may affect the airflow, thereby impacting the purification effect. So the strips may need to be replaced every 3 to 6 months, depending on the amount of dust in the environment.

STEP 1 Shut down the device and unplug the power cord.

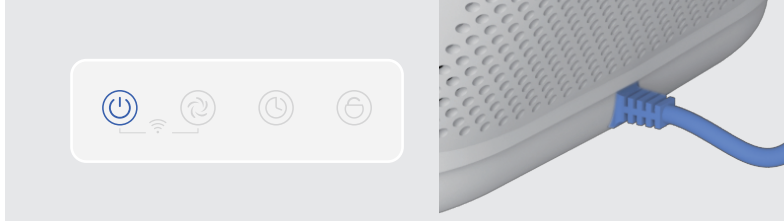

STEP 2 Open the rear cover by its handle, unplug the photocatalyst module's cord, and take out the module.

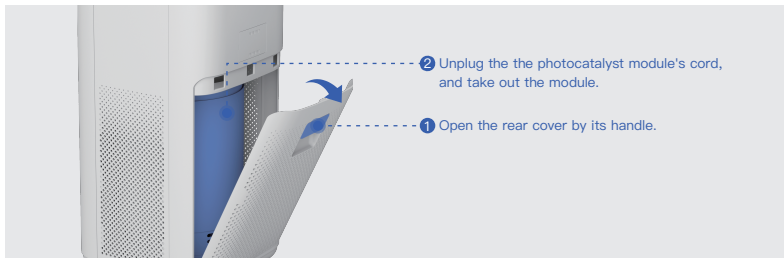

STEP 3 Remove the filter strip while preventing the dust on it from falling in the module. Replace with a new filter strip, with the felt side facing outwards, and stick its two ends together.



STEP 4 Mount back the module, plug back its cord, and close the rear cover. If the cover does not completely fit in, gently tap it to secure it in place.

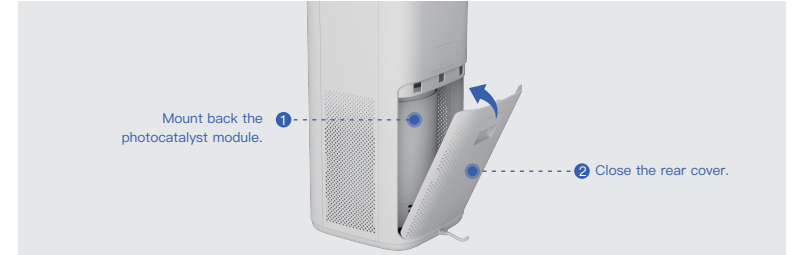

7 Troubleshooting

Error Code	Error Description	Solution
E0	The rear cover is not installed back or closed in place.	Close the rear cover well in place.
E1	The device is not in an upright position.	Put the device upright on the level floor.
EE	Error occurred to the photocatalyst module and its status indicator keeps blinking.	Check the status of the module's connection wire.

8 Cautions

Please do not use alcohol or organic solvents to clean the device or during use, as contact with such solvents may damage the machine or pose a fire risk.

Please ensure that the air inlet and outlet remain clear of any obstructions at all times to avoid affecting the purification performance.